



Hillingdon
Application for a premises licence
Licensing Act 2003

For help contact
applicationsprocessingteam@hillingsdon.gov.uk
 Telephone: 01895 558170

* required information

Section 1 of 21

You can save the form at any time and resume it later. You do not need to be logged in when you resume.

System reference This is the unique reference for this application generated by the system.

Your reference You can put what you want here to help you track applications if you make lots of them. It is passed to the authority.

Are you an agent acting on behalf of the applicant? Put "no" if you are applying on your own behalf or on behalf of a business you own or work for.

Yes No

Applicant Details

* First name

* Family name

* E-mail

Main telephone number Include country code.

Other telephone number

Indicate here if you would prefer not to be contacted by telephone

Are you:

Applying as a business or organisation, including as a sole trader

Applying as an individual

A sole trader is a business owned by one person without any special legal structure. Applying as an individual means you are applying so you can be employed, or for some other personal reason, such as following a hobby.

Applicant Business

Is your business registered in the UK with Companies House? Yes No

Registration number

Business name If your business is registered, use its registered name.

VAT number Put "none" if you are not registered for VAT.

Legal status

Note: completing the Applicant Business section is optional in this form.

Continued from previous page...

Your position in the business

Home country

The country where the headquarters of your business is located.

Registered Address

Address registered with Companies House.

Building number or name

Street

District

City or town

County or administrative area

Postcode

Country

Section 2 of 21

PREMISES DETAILS

I/we, as named in section 1, apply for a premises licence under section 17 of the Licensing Act 2003 for the premises described in section 2 below (the premises) and I/we are making this application to you as the relevant licensing authority in accordance with section 12 of the Licensing Act 2003.

Premises Address

Are you able to provide a postal address, OS map reference or description of the premises?

- Address OS map reference Description

Postal Address Of Premises

Building number or name

Street

District

City or town

County or administrative area

Postcode

Country

Further Details

Telephone number

Non-domestic rateable value of premises (£)

Section 3 of 21

APPLICATION DETAILS

In what capacity are you applying for the premises licence?

- An individual or individuals
- A limited company / limited liability partnership
- A partnership (other than limited liability)
- An unincorporated association
- Other (for example a statutory corporation)
- A recognised club
- A charity
- The proprietor of an educational establishment
- A health service body
- A person who is registered under part 2 of the Care Standards Act 2000 (c14) in respect of an independent hospital in Wales
- A person who is registered under Chapter 2 of Part 1 of the Health and Social Care Act 2008 in respect of the carrying on of a regulated activity (within the meaning of that Part) in an independent hospital in England
- The chief officer of police of a police force in England and Wales

Confirm The Following

- I am carrying on or proposing to carry on a business which involves the use of the premises for licensable activities
- I am making the application pursuant to a statutory function
- I am making the application pursuant to a function discharged by virtue of Her Majesty's prerogative

Section 4 of 21

NON INDIVIDUAL APPLICANTS

Provide name and registered address of applicant in full. Where appropriate give any registered number. In the case of a partnership or other joint venture (other than a body corporate), give the name and address of each party concerned.

Non Individual Applicant's Name

Name

Details

Registered number (where applicable)

Description of applicant (for example partnership, company, unincorporated association etc)

Continued from previous page...

Address

Building number or name	<input type="text" value="The Village Cafe"/>
Street	<input type="text" value="Station Approach"/>
District	<input type="text"/>
City or town	<input type="text" value="London"/>
County or administrative area	<input type="text" value="Middlesex"/>
Postcode	<input type="text" value="UB3 4FE"/>
Country	<input type="text" value="United Kingdom"/>

Contact Details

E-mail	<input type="text"/>
Telephone number	<input type="text"/>
Other telephone number	<input type="text"/>
* Date of birth	<input type="text" value=""/> / <input type="text" value=""/> / <input type="text" value=""/> dd mm yyyy
* Nationality	<input type="text"/>

Section 5 of 21

OPERATING SCHEDULE

When do you want the premises licence to start?	<input type="text" value="07"/> / <input type="text" value="06"/> / <input type="text" value="2020"/>
	dd mm yyyy

If you wish the licence to be valid only for a limited period, when do you want it to end	<input type="text"/> / <input type="text"/> / <input type="text"/>
	dd mm yyyy

Provide a general description of the premises

For example the type of premises, its general situation and layout and any other information which could be relevant to the licensing objectives. Where your application includes off-supplies of alcohol and you intend to provide a place for consumption of these off- supplies you must include a description of where the place will be and its proximity to the premises.

The premises comprise the ground floor of a building.
It will comprise of a restaurant/bar external and internal area.

Continued from previous page...

If 5,000 or more people are expected to attend the premises at any one time, state the number expected to attend

Section 6 of 21

PROVISION OF PLAYS

[See guidance on regulated entertainment](#)

Will you be providing plays?

- Yes No

Section 7 of 21

PROVISION OF FILMS

[See guidance on regulated entertainment](#)

Will you be providing films?

- Yes No

Section 8 of 21

PROVISION OF INDOOR SPORTING EVENTS

[See guidance on regulated entertainment](#)

Will you be providing indoor sporting events?

- Yes No

Section 9 of 21

PROVISION OF BOXING OR WRESTLING ENTERTAINMENTS

[See guidance on regulated entertainment](#)

Will you be providing boxing or wrestling entertainments?

- Yes No

Section 10 of 21

PROVISION OF LIVE MUSIC

[See guidance on regulated entertainment](#)

Will you be providing live music?

- Yes No

Standard Days And Timings

MONDAY

Start

End

Start

End

TUESDAY

Start

End

Start

End

Give timings in 24 hour clock. (e.g., 16:00) and only give details for the days of the week when you intend the premises to be used for the activity.

Continued from previous page...

WEDNESDAY

Start	<input type="text"/>	End	<input type="text"/>
Start	<input type="text"/>	End	<input type="text"/>

THURSDAY

Start	<input type="text"/>	End	<input type="text"/>
Start	<input type="text"/>	End	<input type="text"/>

FRIDAY

Start	<input type="text" value="17:00"/>	End	<input type="text" value="23:00"/>
Start	<input type="text" value="17:00"/>	End	<input type="text" value="23:00"/>

SATURDAY

Start	<input type="text" value="17:00"/>	End	<input type="text" value="23:00"/>
Start	<input type="text" value="17:00"/>	End	<input type="text" value="23:00"/>

SUNDAY

Start	<input type="text"/>	End	<input type="text"/>
Start	<input type="text"/>	End	<input type="text"/>

Will the performance of live music take place indoors or outdoors or both?

- Indoors Outdoors Both

Where taking place in a building or other structure tick as appropriate. Indoors may include a tent.

State type of activity to be authorised, if not already stated, and give relevant further details, for example (but not exclusively) whether or not music will be amplified or unamplified.

music will be amplified at the premises

State any seasonal variations for the performance of live music

For example (but not exclusively) where the activity will occur on additional days during the summer months.

The permitted hours for this activity are to be extended by one hour every:-

- Friday, Saturday, Sunday and Monday of each, Easter Bank Holiday, May Bank Holiday, Spring Bank Holiday, and August Bank Holiday weekend.

Non-standard timings. Where the premises will be used for the performance of live music at different times from those listed in the column on the left, list below

For example (but not exclusively), where you wish the activity to go on longer on a particular day e.g. Christmas Eve.

From the end of permitted hours on New Year's Eve to the start of permitted hours on New Year's Day.

The permitted hours for this activity are to be extended by one hour every:-

Continued from previous page...

• Valentines Night, Christmas Eve, Boxing Day.

Section 11 of 21

PROVISION OF RECORDED MUSIC

[See guidance on regulated entertainment](#)

Will you be providing recorded music?

Yes No

Section 12 of 21

PROVISION OF PERFORMANCES OF DANCE

[See guidance on regulated entertainment](#)

Will you be providing performances of dance?

Yes No

Section 13 of 21

PROVISION OF ANYTHING OF A SIMILAR DESCRIPTION TO LIVE MUSIC, RECORDED MUSIC OR PERFORMANCES OF DANCE

[See guidance on regulated entertainment](#)

Will you be providing anything similar to live music, recorded music or performances of dance?

Yes No

Section 14 of 21

LATE NIGHT REFRESHMENT

Will you be providing late night refreshment?

Yes No

Section 15 of 21

SUPPLY OF ALCOHOL

Will you be selling or supplying alcohol?

Yes No

Standard Days And Timings

MONDAY

Start

End

Start

End

Give timings in 24 hour clock.
(e.g., 16:00) and only give details for the days
of the week when you intend the premises
to be used for the activity.

TUESDAY

Start

End

Start

End

WEDNESDAY

Start

End

Start

End

Continued from previous page...

THURSDAY

Start End

Start End

FRIDAY

Start End

Start End

SATURDAY

Start End

Start End

SUNDAY

Start End

Start End

Will the sale of alcohol be for consumption:

- On the premises Off the premises Both

If the sale of alcohol is for consumption on the premises select on, if the sale of alcohol is for consumption away from the premises select off. If the sale of alcohol is for consumption on the premises and away from the premises select both.

State any seasonal variations

For example (but not exclusively) where the activity will occur on additional days during the summer months.

The closing time is to be extended by one hour every:-

- Friday, Saturday, Sunday and Monday of each, Easter Bank Holiday, May Bank Holiday, Spring Bank Holiday, and August Bank Holiday weekend.

Non-standard timings. Where the premises will be used for the supply of alcohol at different times from those listed in the column on the left, list below

For example (but not exclusively), where you wish the activity to go on longer on a particular day e.g. Christmas Eve.

From the end of permitted hours on New Year's Eve to the start of permitted hours on New Year's Day.

The closing time is to be extended by one hour every:-

- Valentines Night, Christmas Eve, Boxing Day and New years Eve.

State the name and details of the individual whom you wish to specify on the licence as premises supervisor

Continued from previous page...

Name

First name

Family name

Date of birth / /
dd mm yyyy

Enter the contact's address

Building number or name

Street

District

City or town

County or administrative area

Postcode

Country

Personal Licence number (if known)

Issuing licensing authority (if known)

PROPOSED DESIGNATED PREMISES SUPERVISOR CONSENT

How will the consent form of the proposed designated premises supervisor be supplied to the authority?

- Electronically, by the proposed designated premises supervisor
- As an attachment to this application

Reference number for consent form (if known)

If the consent form is already submitted, ask the proposed designated premises supervisor for its 'system reference' or 'your reference'.

Section 16 of 21

ADULT ENTERTAINMENT

Highlight any adult entertainment or services, activities, or other entertainment or matters ancillary to the use of the premises that may give rise to concern in respect of children

Give information about anything intended to occur at the premises or ancillary to the use of the premises which may give rise to concern in respect of children, regardless of whether you intend children to have access to the premises, for example (but not exclusively) nudity or semi-nudity, films for restricted age groups etc gambling machines etc.

NONE

Continued from previous page...

Section 17 of 21

HOURS PREMISES ARE OPEN TO THE PUBLIC

Standard Days And Timings

MONDAY

Start

End

Start

End

Give timings in 24 hour clock.
(e.g., 16:00) and only give details for the days
of the week when you intend the premises
to be used for the activity.

TUESDAY

Start

End

Start

End

WEDNESDAY

Start

End

Start

End

THURSDAY

Start

End

Start

End

FRIDAY

Start

End

Start

End

SATURDAY

Start

End

Start

End

SUNDAY

Start

End

Start

End

State any seasonal variations

For example (but not exclusively) where the activity will occur on additional days during the summer months.

From the end of permitted hours on New Year's Eve to the start of permitted hours on New Year's Day.

The closing time is to be extended by one hour every:-

- Friday, Saturday, Sunday and Monday of each, Easter Bank Holiday, May Bank Holiday, Spring Bank Holiday, and August Bank Holiday weekend.

Non standard timings. Where you intend to use the premises to be open to the members and guests at different times from those listed in the column on the left, list below

For example (but not exclusively), where you wish the activity to go on longer on a particular day e.g. Christmas Eve.

Continued from previous page...

Christmas Eve from 12pm - 00.00. New Years Eve from 12:00pm - 02.00am New Years Day.

Section 18 of 21

LICENSING OBJECTIVES

Describe the steps you intend to take to promote the four licensing objectives:

a) General – all four licensing objectives (b,c,d,e)

List here steps you will take to promote all four licensing objectives together.

Regular checks for any possible risk to the public safety.

b) The prevention of crime and disorder

A CCTV system will be operated inside and outside the premises at all hours for security and to prevent crime and disorder. CCTV images will be available for inspection to the Police or their representatives.

Whenever licensable activities are available at the premises a waiter/waitress service shall be available.

The premises license holder shall risk assess the requirement for door supervisors at the premises, and shall employ door supervisors in such numbers and at such times as is deemed necessary by the risk assessment. All door staff employed at the entrance/exit of the licensed premises shall be SIA trained.

Security arrangements shall be sufficient to discourage the sale and consumption of drugs and shall ensure such arrangements include regular checks of toilet areas.

At least one personal license holder will be contactable while the supply or sale of alcohol is being undertaken (whose identity will be known to all other staff engaged in the supply or sale of alcohol) except in the case of emergency.

CCTV shall be installed internally and externally at the premises and will comply with the following:

The CCTV system shall be installed, maintained and operated to the reasonable satisfaction to the Constabulary. All public areas of the premises are to be covered by the system. The system will incorporate a camera covering the entrance door and will be capable of providing an image which is regarded as identification standard.

The system will display the correct date and time

The system will make recordings during all hours the premises are open to the public

VCR tapes or digital recordings shall be held for a minimum of 21 days after the recording is made and will be made available to the Police or any authorized persons for inspection upon request.

The system will, as a minimum, record images of the head and shoulders of all persons entering the premises.

A staff member who is conversant with the operation of the CCTV system will be on the premises at all times the premises are open to the public. This staff member will be able to show recent data or footage with the absolute minimum of delay when requested to by a Police Officer or a Local Authority Enforcement Officer.

No person in possession of a drink in a sealed or unsealed container will be allowed to enter the premises except for the purposes of delivery.

No drink will be removed from the premises in an unsealed container save for unfinished bottles of wine which must be re-corked before being taken away from the premises.

Appropriate measures shall be taken to ensure staff prevent the removal of bottles or glasses from the curtilage and grounds of the licensed premises or any outside area under the control of the premises license holder.

Continued from previous page...

Frequent collection of glasses and bottles shall be undertaken to ensure that empty containers do not accumulate in or around the licensed premises

Off sales from the premises shall be in sealed containers only.

An incident book will be maintained in which shall be recorded:-

- a. All incidents of crime and disorder
- b. Refused sales to suspected under-age and drunken persons
- c. A record of any person asked to leave the premises or removed from the premises
- d. Details of occasions on which the police are called to the premises

The book will be available for inspection by a police officer.

Any risk assessments carried out by or on behalf of the License holder, which relate to a licensing objective shall be available for inspection by an officer of a Responsible Authority.

All staff who are involved in the sale of alcohol shall be trained in relation to the licensing objectives so as to reduce crime and disorder, promote public safety, prevent public nuisance and promote the protection of children from harm. Said training shall be documented and shall be made available to an authorized officer upon request.

Any person who appears to be intoxicated or who is behaving in a disorderly manner will not be allowed entry to the premises. Any person within the premises who appears to be intoxicated or who is behaving in a disorderly manner will be given care and consideration in leaving the premises.

A well designed physical barrier of approximately 1.0 meter in height shall be erected around the outdoor licensed area whenever the outside area of the premises are in use and open to members of the public. Regular checks of the area must be made at not less than 30 minute intervals.

The external seating area at the front of the premises shall not be used for the consumption of drink beyond 22:00hrs. All tables and chairs in the outside area shall be stacked and removed promptly and in any event no later than 30 minutes after the time at which patrons are no longer permitted to consume drinks in the area.

All customers in the outside area, must be seated.

No entertainment of an "adult" or "sexual" nature will take place on the premises.

c) Public safety

The premises shall operate in accordance with all relevant legislation which promotes the public safety objective including, but not limited to, the Health and Safety at Work etc Act 1974 and associate regulations, the Food Safety Act 1990, the Regulatory Reform (Fire Safety) Order 2005 and the Disability Discrimination Act 1995.

Adequate first aid provision and fire-fighting will be available at all times on the premises.

d) The prevention of public nuisance

The Premises License Holder shall operate in accordance with all relevant legislation which promotes the public nuisance objective including but not limited to the Environmental Protection Act 1990 and the Noise Act 1996.

The departure of customers from the premises shall be effectively managed by staff who will request patrons to leave

Continued from previous page...

quietly and to avoid causing noise, nuisance or disturbance in the area.

The area around the premises will be kept clean, tidy and free from debris and cigarette butts so as not to cause a nuisance in the area.

There will be placed at all exits from the premises, in a place where they can be seen and easily read by patrons, clear and legible notices requiring customers to leave the premises and the area quietly so as to minimize disturbance in the vicinity.

e) The protection of children from harm

Any person who looks or appears to be under the age of 25 shall be asked to provide identification that they are over the age of 18. The following are the only forms of identification acceptable:

- i. A recognized proof of age card accredited under the British Retail Consortium's Proof of Age Standards Scheme (PASS)
- ii. Photo driving licence
- iii. Citizen card supported by the Home Office
- iv. Official ID card issued by HM Forces or European Union bearing a photograph and date of birth of the holder.

If no suitable identification is provided, the sale of alcohol to them will be refused.

All staff who are involved in the sale of alcohol shall be trained in relation to the Challenge 25 policy upon commencement of their employment following which they will undertake refresher training at suitable intervals. Records to evidence this will be made available to an authorized officer upon request.

Suitable signage will be displayed to specify that a Challenge 25 Policy is in place.

Section 19 of 21

NOTES ON DEMONSTRATING ENTITLEMENT TO WORK IN THE UK

Continued from previous page...

Entitlement to work/immigration status for individual applicants and applications from partnerships which are not limited liability partnerships:

A licence may not be held by an individual or an individual in a partnership who is resident in the UK who:

- does not have the right to live and work in the UK; or
- is subject to a condition preventing him or her from doing work relating to the carrying on of a licensable activity.

Any premises licence issued in respect of an application made on or after 6 April 2017 will become invalid if the holder ceases to be entitled to work in the UK.

Applicants must demonstrate that they have an entitlement to work in the UK and are not subject to a condition preventing them from doing work relating to the carrying on of a licensable activity. They do this in one of two ways: 1) by providing with this application copies or scanned copies of the documents listed below (which do not need to be certified), or 2) by providing their 'share code' to enable the licensing authority to carry out a check using the Home Office online right to work checking service (see below).

Documents which demonstrate entitlement to work in the UK

- An expired or current passport showing the holder, or a person named in the passport as the child of the holder, is a British citizen or a citizen of the UK and Colonies having the right of abode in the UK [please see note below about which sections of the passport to copy].
- An expired or current passport or national identity card showing the holder, or a person named in the passport as the child of the holder, is a national of a European Economic Area country or Switzerland.
- A Registration Certificate or document certifying permanent residence issued by the Home Office to a national of a European Economic Area country or Switzerland.
- A Permanent Residence Card issued by the Home Office to the family member of a national of a European Economic Area country or Switzerland.
- A **current** Biometric Immigration Document (Biometric Residence Permit) issued by the Home Office to the holder indicating that the person named is allowed to stay indefinitely in the UK, or has no time limit on their stay in the UK.
- A **current** passport endorsed to show that the holder is exempt from immigration control, is allowed to stay indefinitely in the UK, has the right of abode in the UK, or has no time limit on their stay in the UK.
- A **current** Immigration Status Document issued by the Home Office to the holder with an endorsement indicating that the named person is allowed to stay indefinitely in the UK or has no time limit on their stay in the UK, **when produced in combination with** an official document giving the person's permanent National Insurance number and their name issued by a Government agency or a previous employer.
- A birth or adoption certificate issued in the UK, **when produced in combination with** an official document giving the person's permanent National Insurance number and their name issued by a Government agency or a previous employer.
- A birth or adoption certificate issued in the Channel Islands, the Isle of Man or Ireland **when produced in combination with** an official document giving the person's permanent National Insurance number and their name issued by a Government agency or a previous employer.
- A certificate of registration or naturalisation as a British citizen, **when produced in combination with** an official document giving the person's permanent National Insurance number and their name issued by a Government agency or a previous employer.

Continued from previous page...

- A **current** passport endorsed to show that the holder is allowed to stay in the UK and is currently allowed to work and is not subject to a condition preventing the holder from doing work relating to the carrying on of a licensable activity.
- A **current** Biometric Immigration Document (Biometric Residence Permit) issued by the Home Office to the holder which indicates that the named person can currently stay in the UK and is allowed to work relation to the carrying on of a licensable activity.
- A **current** Residence Card issued by the Home Office to a person who is not a national of a European Economic Area state or Switzerland but who is a family member of such a national or who has derivative rights or residence.
- A **current** Immigration Status Document containing a photograph issued by the Home Office to the holder with an endorsement indicating that the named person may stay in the UK, and is allowed to work and is not subject to a condition preventing the holder from doing work relating to the carrying on of a licensable activity **when produced in combination with** an official document giving the person's permanent National Insurance number and their name issued by a Government agency or a previous employer.
- A Certificate of Application, **less than 6 months old**, issued by the Home Office under regulation 18(3) or 20(2) of the Immigration (European Economic Area) Regulations 2016, to a person who is not a national of a European Economic Area state or Switzerland but who is a family member of such a national or who has derivative rights of residence.
- Reasonable evidence that the person has an outstanding application to vary their permission to be in the UK with the Home Office such as the Home Office acknowledgement letter or proof of postage evidence, or reasonable evidence that the person has an appeal or administrative review pending on an immigration decision, such as an appeal or administrative review reference number.
- Reasonable evidence that a person who is not a national of a European Economic Area state or Switzerland but who is a family member of such a national or who has derivative rights of residence in exercising treaty rights in the UK including:-
 - evidence of the applicant's own identity – such as a passport,
 - evidence of their relationship with the European Economic Area family member – e.g. a marriage certificate, civil partnership certificate or birth certificate, and
 - evidence that the European Economic Area national has a right of permanent residence in the UK or is one of the following if they have been in the UK for more than 3 months:
 - (i) working e.g. employment contract, wage slips, letter from the employer,
 - (ii) self-employed e.g. contracts, invoices, or audited accounts with a bank,
 - (iii) studying e.g. letter from the school, college or university and evidence of sufficient funds; or
 - (iv) self-sufficient e.g. bank statements.

Family members of European Economic Area nationals who are studying or financially independent must also provide evidence that the European Economic Area national and any family members hold comprehensive sickness insurance in the UK. This can include a private medical insurance policy, an EHIC card or an S1, S2 or S3 form.

Original documents must not be sent to licensing authorities. If the document copied is a passport, a copy of the following pages should be provided:-

- (i) any page containing the holder's personal details including nationality;
- (ii) any page containing the holder's photograph;
- (iii) any page containing the holder's signature;
- (iv) any page containing the date of expiry; and
- (v) any page containing information indicating the holder has permission to enter or remain in the UK and is permitted to work.

Continued from previous page...

If the document is not a passport, a copy of the whole document should be provided.

Your right to work will be checked as part of your licensing application and this could involve us checking your immigration status with the Home Office. We may otherwise share information with the Home Office. Your licence application will not be determined until you have complied with this guidance.

Home Office online right to work checking service

As an alternative to providing a copy of the documents listed above, applicants may demonstrate their right to work by allowing the licensing authority to carry out a check with the Home Office online right to work checking service.

To demonstrate their right to work via the Home Office online right to work checking service, applicants should include in this application their 9-digit share code (provided to them upon accessing the service at <https://www.gov.uk/prove-right-to-work>) which, along with the applicant's date of birth (provided within this application), will allow the licensing authority to carry out the check.

In order to establish the applicant's right to work, the check will need to indicate that the applicant is allowed to work in the United Kingdom and is not subject to a condition preventing them from doing work relating to the carrying on of a licensable activity.

An online check will not be possible in all circumstances because not all applicants will have an immigration status that can be checked online. The Home Office online right to work checking service sets out what information and/or documentation applicants will need in order to access the service. Applicants who are unable to obtain a share code from the service should submit copy documents as set out above.

Section 20 of 21

NOTES ON REGULATED ENTERTAINMENT

Continued from previous page...

In terms of specific **regulated entertainments** please note that:

- Plays: no licence is required for performances between 08:00 and 23.00 on any day, provided that the audience does not exceed 500.
- Films: no licence is required for 'not-for-profit' film exhibition held in community premises between 08.00 and 23.00 on any day provided that the audience does not exceed 500 and the organiser (a) gets consent to the screening from a person who is responsible for the premises; and (b) ensures that each such screening abides by age classification ratings.
- Indoor sporting events: no licence is required for performances between 08.00 and 23.00 on any day, provided that the audience does not exceed 1000.
- Boxing or Wrestling Entertainment: no licence is required for a contest, exhibition or display of Greco-Roman wrestling, or freestyle wrestling between 08.00 and 23.00 on any day, provided that the audience does not exceed 1000. Combined fighting sports – defined as a contest, exhibition or display which combines boxing or wrestling with one or more martial arts – are licensable as a boxing or wrestling entertainment rather than an indoor sporting event.
- Live music: no licence permission is required for:
 - o a performance of unamplified live music between 08.00 and 23.00 on any day, on any premises.
 - o a performance of amplified live music between 08.00 and 23.00 on any day on premises authorised to sell alcohol for consumption on those premises, provided that the audience does not exceed 500.
 - o a performance of amplified live music between 08.00 and 23.00 on any day, in a workplace that is not licensed to sell alcohol on those premises, provided that the audience does not exceed 500.
 - o a performance of amplified live music between 08.00 and 23.00 on any day, in a church hall, village hall, community hall, or other similar community premises, that is not licensed by a premises licence to sell alcohol, provided that (a) the audience does not exceed 500, and (b) the organiser gets consent for the performance from a person who is responsible for the premises.
 - o a performance of amplified live music between 08.00 and 23.00 on any day, at the non-residential premises of (i) a local authority, or (ii) a school, or (iii) a hospital, provided that (a) the audience does not exceed 500, and (b) the organiser gets consent for the performance on the relevant premises from: (i) the local authority concerned, or (ii) the school or (iii) the health care provider for the hospital.
- Recorded Music: no licence permission is required for:
 - o any playing of recorded music between 08.00 and 23.00 on any day on premises authorised to sell alcohol for consumption on those premises, provided that the audience does not exceed 500.
 - o any playing of recorded music between 08.00 and 23.00 on any day, in a church hall, village hall, community hall, or other similar community premises, that is not licensed by a premises licence to sell alcohol, provided that (a) the audience does not exceed 500, and (b) the organiser gets consent for the performance from a person who is responsible for the premises.
 - o any playing of recorded music between 08.00 and 23.00 on any day, at the non-residential premises of (i) a local authority, or (ii) a school, or (iii) a hospital, provided that (a) the audience does not exceed 500, and (b) the organiser gets consent for the performance on the relevant premises from: (i) the local authority concerned, or (ii) the school proprietor or (iii) the health care provider for the hospital.

Continued from previous page...

- Dance: no licence is required for performances between 08.00 and 23.00 on any day, provided that the audience does not exceed 500. However, a performance which amounts to adult entertainment remains licensable.
- Cross activity exemptions: no licence is required between 08.00 and 23.00 on any day, with no limit on audience size for:
 - o any entertainment taking place on the premises of the local authority where the entertainment is provided by or on behalf of the local authority;
 - o any entertainment taking place on the hospital premises of the health care provider where the entertainment is provided by or on behalf of the health care provider;
 - o any entertainment taking place on the premises of the school where the entertainment is provided by or on behalf of the school proprietor; and
 - o any entertainment (excluding films and a boxing or wrestling entertainment) taking place at a travelling circus, provided that (a) it takes place within a moveable structure that accommodates the audience, and (b) that the travelling circus has not been located on the same site for more than 28 consecutive days.

Section 21 of 21

PAYMENT DETAILS

This fee must be paid to the authority. If you complete the application online, you must pay it by debit or credit card. Premises' licence fees are determined by the non-domestic rateable value of the premises. To find out a premises' non-domestic rateable value, go to the Valuation Office Agency website at http://www.voa.gov.uk/business_rates/index.htm. For full details, refer to the 'Fees for Applications' webpage: <http://www.hillingdon.gov.uk/media.jsp?mediaid=22879&filetype=pdf>

* Fee amount (£)

DECLARATION

* I/we understand it is an offence, liable on conviction to a fine up to level 5 on the standard scale, under section 158 of the licensing act 2003, to make a false statement in or in connection with this application.

Ticking this box indicates you have read and understood the above declaration

This section should be completed by the applicant, unless you answered "Yes" to the question "Are you an agent acting on behalf of the applicant?"

* Full name

* Capacity

* Date

 / /
dd mm yyyy

Add another signatory

Once you're finished you need to do the following:

1. Save this form to your computer by clicking file/save as...

2. Go back to <https://www.gov.uk/apply-for-a-licence/premises-licence/hillingdon/apply-1> to upload this file and continue with your application.

Don't forget to make sure you have all your supporting documentation to hand.

Continued from previous page...

IT IS AN OFFENCE LIABLE TO SUMMARY CONVICTION TO A FINE OF ANY AMOUNT UNDER SECTION 158 OF THE LICENSING ACT 2003, TO MAKE A FALSE STATEMENT IN OR IN CONNECTION WITH THIS APPLICATION

IT IS AN OFFENCE UNDER SECTION 24B OF THE IMMIGRATION ACT 1971 FOR A PERSON TO WORK WHEN THEY KNOW, OR HAVE REASONABLE CAUSE TO BELIEVE, THAT THEY ARE DISQUALIFIED FROM DOING SO BY REASON OF THEIR IMMIGRATION STATUS. THOSE WHO EMPLOY AN ADULT WITHOUT LEAVE OR WHO IS SUBJECT TO CONDITIONS AS TO EMPLOYMENT WILL BE LIABLE TO A CIVIL PENALTY UNDER SECTION 15 OF THE IMMIGRATION, ASYLUM AND NATIONALITY ACT 2006 AND PURSUANT TO SECTION 21 OF THE SAME ACT, WILL BE COMMITTING AN OFFENCE WHERE THEY DO SO IN THE KNOWLEDGE, OR WITH REASONABLE CAUSE TO BELIEVE, THAT THE EMPLOYEE IS DISQUALIFIED

OFFICE USE ONLY

Applicant reference number	<input type="text" value="2020"/>
Fee paid	<input type="text"/>
Payment provider reference	<input type="text"/>
ELMS Payment Reference	<input type="text"/>
Payment status	<input type="text"/>
Payment authorisation code	<input type="text"/>
Payment authorisation date	<input type="text"/>
Date and time submitted	<input type="text"/>
Approval deadline	<input type="text"/>
Error message	<input type="text"/>
Is Digitally signed	<input type="checkbox"/>

[1](#) [2](#) [3](#) [4](#) [5](#) [6](#) [7](#) [8](#) [9](#) [10](#) [11](#) [12](#) [13](#) [14](#) [15](#) [16](#) [17](#) [18](#) [19](#) [20](#) [21](#) [Next >](#)

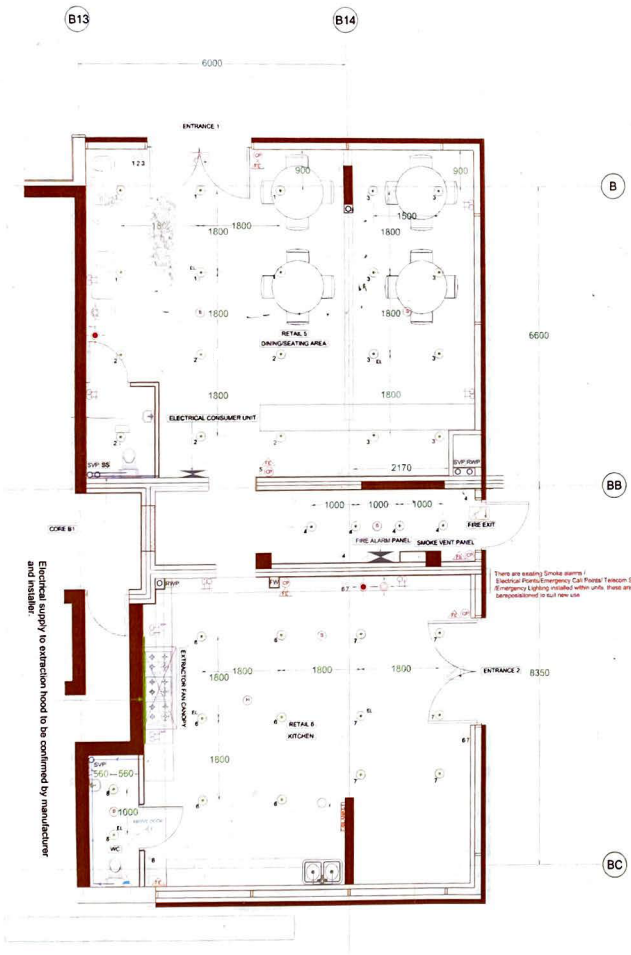

PROPOSED LAYOUT
SCALE BAR 1:50 @ A1



ventilation

All habitable rooms to have rapid ventilation via windows/doors of an openable area of at least 1/20th of the floor area, part of the ventilation area is to be 1.75m above floor area.

Windows are to provide 4000 sq/mm minimum of background ventilation via controlled trickle vents in utility room, en suite and bedroom. All habitable rooms to achieve 8000 sq/mm externally the sum of all trickle vents must equal 6000 sq/mm as specified in Table 1 of approved document F1.

Kitchens to be ventilated mechanically with a wall mounted fan which can achieve extract to external air @ 30 litres per second. WC to provide 15 litres per second to external air.

Mechanical vents are to be tested and commissioned in accordance with regulation 42 and part F1 2010

Electrical Installation

The electrical installation is to be in full accordance with BS 7671 and with the latest edition of IEE wiring regulations part 7th building regs, and should be carried out in accordance with current installation techniques applicable to the material and equipment being used.

All completion certificates to be issued by a certified electrical engineer to be provided upon completion of the electrical installation.

All cable that all wiring which is covered or surrounded with thermal insulation to be derated in accordance with Appendix A of BRE 'Thermal insulation', avoiding risks 2002 edition.

All lightings in first floor ceiling voids are to be fitted with intumescent covers to maintain one hour fire resistance.

All light switches are to be fitted 1200mm from finished floor level and all switched outlets to be fitted 40mm above finished floor levels.

All light fittings to have a luminous efficiency of 45 Lumens or greater

ELECTRICAL KEY:

- LED DOWNLIGHTER
- DOWNLIGHTER (EMERGENCY FITTING)
- LIGHT SWITCH
- DOUBLE PUSH SWITCH
- ABOUT WORK TOP
- EXTRACTOR FAN W/IC - FEEDS DIRECT TO EXTERNAL AIR
- EXTRACTOR FAN ISOLATOR SWITCH

DETECTION/PREVENTION KEY:

- SMOKE DETECTOR
- SMOKE DETECTOR
- SMOKE DETECTOR
- FIRE ALARM CALL POINT
- FIRE EXTINGUISHER
- FIRE BLANKET
- FIRE ALARM SOUNDING LIGHT
- FIRE ALARM OTHER SOUNDING LIGHT
- ILLUMINATED RUNNING WAY EXIT SIGNAGE

Fire Alarm system to be installed to minimum L1 standard
Smoke detection system to be designed and installed in accordance with BS5839-6:2004 and BS 5446-1:2002 and BS 5446-2:2003. Detectors are to be mains operated with a secondary power supply for backup and interlinked.

SHOWN AS NOTED
This drawing is the property of Greenfields Architectural Services and is not to be used for any other project without the written consent of Greenfields Architectural Services. It is to be used only for the project and site mentioned herein. It is not to be used for any other project without the written consent of Greenfields Architectural Services. It is not to be used for any other project without the written consent of Greenfields Architectural Services. It is not to be used for any other project without the written consent of Greenfields Architectural Services.

PLAN No 1813/16/A

Greenfields Architectural Services	
LONDON OFFICE: 111 Downes Road Fulham London SW9 7DU 0207 386 4138	DESIGN OFFICE: 111 Station Approach Chertsey Surrey TW20 1LE 01883 871 967
E-mail: enquiries@greenfieldsarchitecturalservices.co.uk Website: www.greenfieldsarchitecturalservices.co.uk	
DRAWING TITLE: PROPOSED ELECTRICAL & FIRE DETECTION 1:50/0 PLAN	
SITE ADDRESS: UNIT 8 & 9 SOUTH FERRY VILLAGE STATION APPROACH, HAYES, UB8 4PE	
SCALE: 1:50 @ A1	DESIGN BY: BS
DATE: 27.08.18	
DRAWING NO: 1813/16/A	